

Study Item/ Area	(New) Graduate House
Acton Campus Precinct	GARRAN Precinct
Building Nos. & Names	118 ((New) Graduate House)

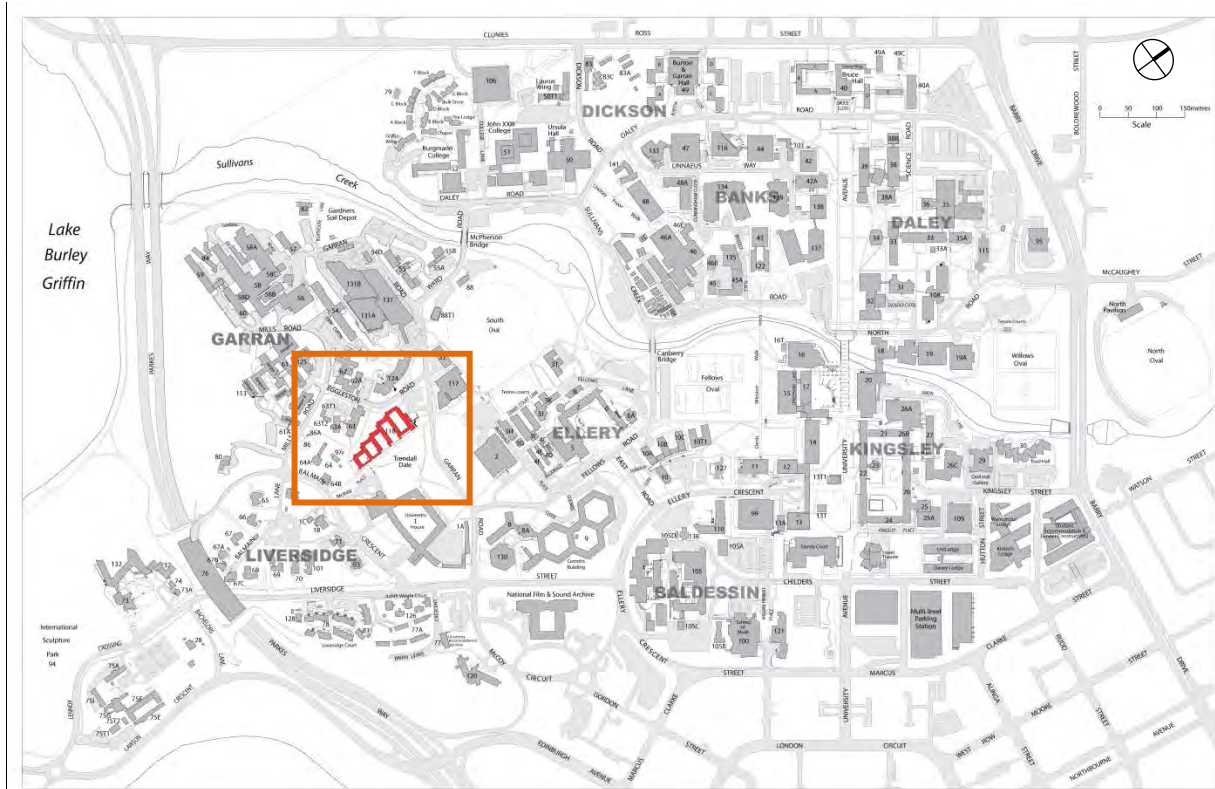

Figure 1: Location of study area within the ANU Acton Campus site.

Heritage Ranking	(New) Graduate House—Neutral—Does not meet criteria for Commonwealth Heritage List
Heritage Listing	(New) Graduate House is not individually listed on the Commonwealth Heritage List (CHL).
Condition—Date	The condition noted here is at November 2011. The extant buildings and trees of (New) Graduate House area continue to be well maintained for student accommodation are in good condition.
Relevant Documentation	There is no current documentation for this building.

### Context of the Buildings

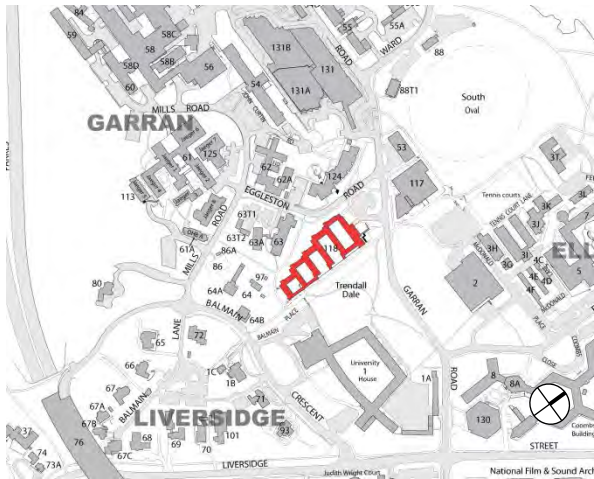

Figure 2: New Graduate House in relation to the surrounding buildings in the campus precincts of Garran and Liversidge.

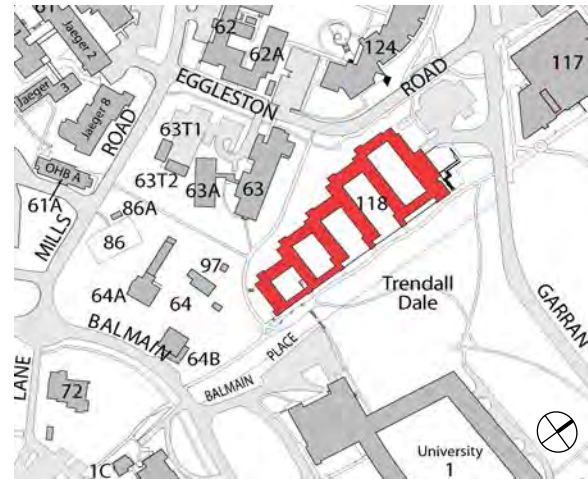

Figure 3: Configuration of New Graduate House in relation to University House to the east and Eggleston Road to the west.

### Brief Historical Overview

With the expansion of the graduate population of the ANU, a new accommodation building was required and Project Coordination (Australia) Pty Ltd were contracted to oversee the building of (New) Graduate House (An existing building known as Graduate House was constructed in 1971 on Northbourne Avenue). (New) Graduate House was completed and officially opened in November 1998.

(New) Graduate House provides single and limited double self-catered accommodation for fulltime postgraduate students of the ANU. Accommodation is also available to visiting graduate students from other universities.

The building includes sculpted screens by the Sydney artist Michael Snape. These custom screens have been reported on in publications such as 'Industry Review' and the 'Sydney Morning Herald'. The works came to a cost of \$30,657.99.

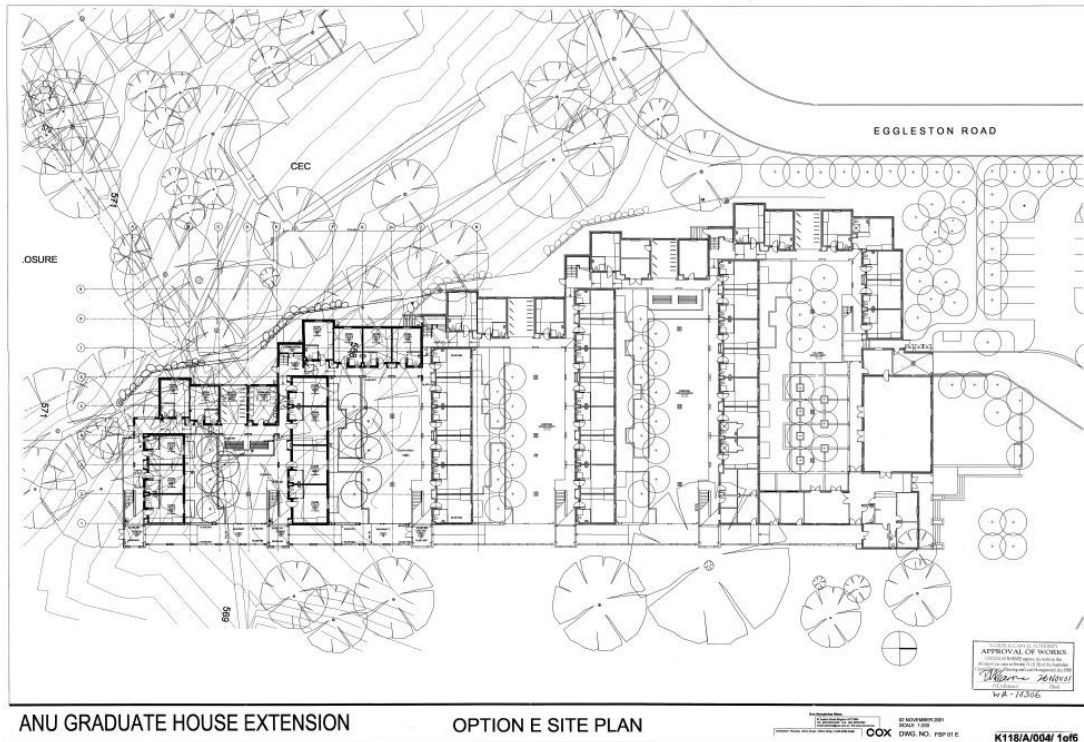

Figure 4: 1998 Site plan for (New) Graduate House designed by Cox Architects and built by Project Coordination (Australia). Construction was completed in 1998.

## Description of Graduate House

### Building

(New) Graduate House is a three storey complex on a sloping site. It is constructed of a concrete slab with Boral bricks, roofed with Pioneer clear glazed terracotta roof tiles. Doors, windows and external plumbing are powder coated metal. Internal cladding is white painted plasterboard with the common room clad in painted timber. Rooms are self-contained with single side hung opening windows on second and third floor. Ground floor rooms have aluminium framed sliding glass doors opening onto internal courtyards. Internal furnishings are standard throughout.

### Landscape

The area around (New) Graduate House is heavily landscaped with five internal courtyards and rose garden area by the front entrance. Bedded gardens run along the eastern wall with a pebbled cement walkway separating the (New) Graduate and University House properties.

## Significance Assessment against the Commonwealth Heritage criteria

### Statement of Significance

N/A

Criteria	Assessment
<p><b>(a) Historic</b> The place has significant heritage value because of the place's importance in the course, or pattern, of Australia's natural or cultural history.</p>	<p>(New) Graduate House does not meet CHL criterion (a) for historic values.</p>
<p><b>(b) Rarity</b> The place has significant heritage values because of the place's possession of uncommon, rare or endangered aspects of Australia's natural or cultural history.</p>	<p>(New) Graduate House does not meet CHL criterion (b) for rarity values.</p>
<p><b>(c) Scientific</b> The place has significant heritage value because of the place's potential to yield information that will contribute to an understanding of Australia's natural or cultural history.</p>	<p>(New) Graduate House does not meet CHL criterion (c) for scientific values.</p>
<p><b>(d) Representative</b> The place has significant heritage value because of the place's importance in demonstrating the principal characteristics of: A class of Australia's natural or cultural places; or A class of Australia's natural or cultural environments.</p>	<p>(New) Graduate House does not meet CHL criterion (d) for representative values.</p>

## Significance Assessment against the Commonwealth Heritage criteria

<p><b>(e) Aesthetic</b> The place has significant heritage value because of the place's importance in exhibiting particular aesthetic characteristics valued by a community or cultural group.</p>	<p>(New) Graduate House does not meet CHL criterion (e) for aesthetic values.</p>
<p><b>(f) Creative/Technical</b> The place has significant heritage value because of the place's importance in demonstrating a high degree of creative or technical achievement at a particular period.</p>	<p>(New) Graduate House does not meet CHL criterion (f) for creative/technical values.</p>
<p><b>(g) Social</b> The place has significant heritage value because of the place's strong or special association with a particular community or cultural group for social, cultural or spiritual reasons.</p>	<p>(New) Graduate House does not meet CHL criterion (g) for social values.</p>
<p><b>(h) Associative</b> The place has significant heritage value because of the place's special association with the life or works of a person, or group of persons, of importance in Australia's natural and cultural history.</p>	<p>(New) Graduate House does not meet CHL criterion (h) for associative values.</p>
<p><b>(i) Indigenous</b> The place has significant heritage value because of the place's importance as part of Indigenous tradition.</p>	<p>(New) Graduate House does not meet CHL criterion (i) for Indigenous values.</p>



## Photographs



Figure 5: Front entrance of (New) Graduate House. (Source: ANU Heritage Office 2011)



Figure 6: Detail of Michael Snape's decorative screens on the east face of the building. (Source: ANU Heritage Office 2011)



Figure 7: Feature rose garden at the entrance to (New) Graduate House. (Source: ANU Heritage Office 2011)



Figure 8: The western face of the building including access ramp and landscaping. (Source: ANU Heritage Office 2011)



Figure 9: Eastern wall of (New) Graduate House, including gardens and walkway. (Source: ANU Heritage Office 2011)



Figure 10: Typical accommodation style including kitchenette. (Source: ANU Heritage Office 2011)

## Management Issues

### Constraints and Opportunities

---

As (New) Graduate House Building is of neutral significance, no **constraints** are noted.

(New) Graduate House is ranked as being of 'Neutral' significance as it does not embody, reflect or demonstrate Commonwealth or National Heritage values. The building makes no contribution to the site nor does it detract from the overall heritage values of the ANU Acton campus.

The **Tolerance for Change** heritage management tool, outlined in Section 7.6 of the ANU Acton Campus Heritage Study 2012, will assist in conserving heritage values through a process of change. (New) Graduate House is able to tolerate a substantial amount of change through development. Removal of neutral elements is not necessary unless it allows for heritage values of the campus to be regained, reinforced or conserved.

As (New) Graduate House is of neutral significance, no **opportunities** are noted.

---

### Recommendations

---

Photographic recording for the ANU archives should be undertaken prior to substantial change to buildings or landscaping in any future development.

---