

# Australian National University

## Acton Campus — Site Inventory



Study Item/ Area	Judith Wright Court
Acton Campus Precinct	LIVERSIDGE Precinct
Building Nos. & Names	126-1 (Units 1-4), 126-2 (Units 5-8), 126-3 (Units 9-14), 126-4 (Units 15-20), 126-5 (Units 21-26), 126-6 (Waste facilities)

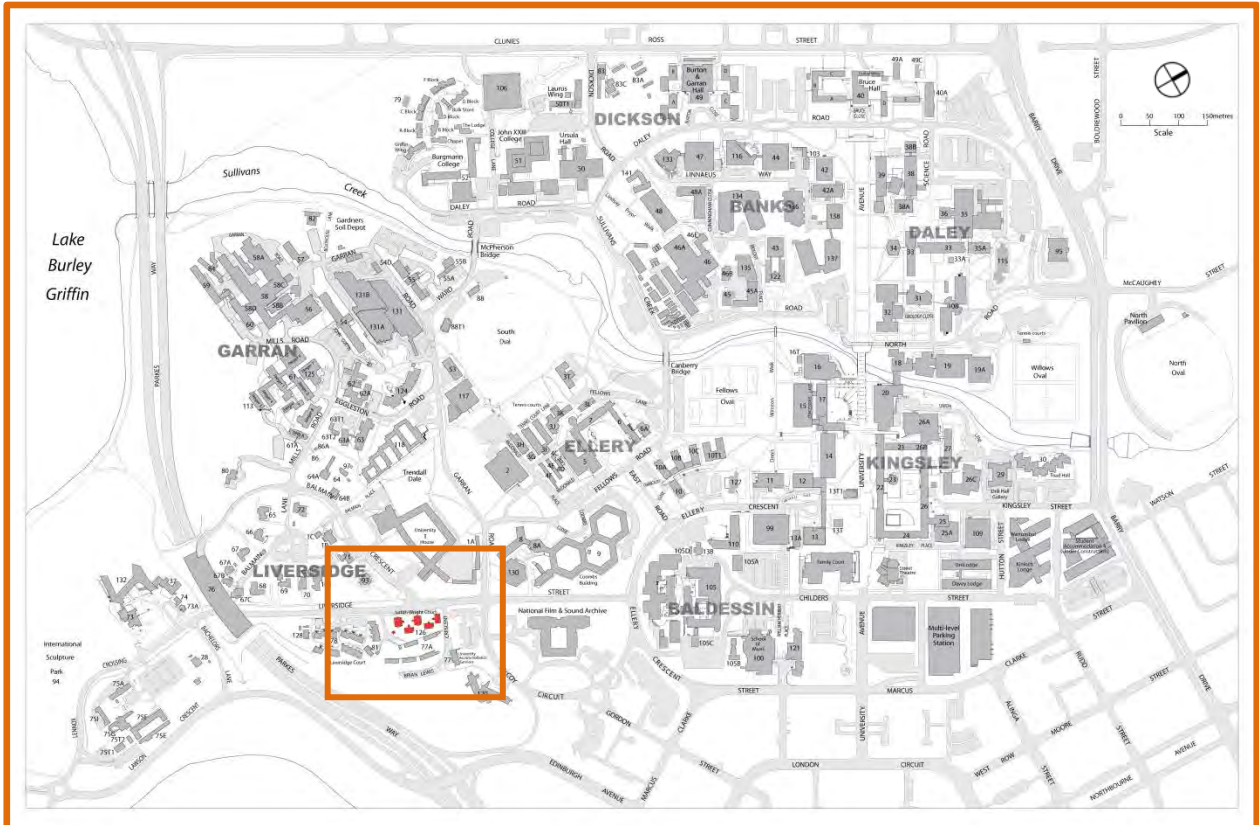

Figure 1: Location of study area within the ANU Acton Campus site.

Heritage Ranking	Judith Wright Court—Neutral—does not meet criteria for Commonwealth Heritage List
Heritage Listing	Judith Wright Court is not individually listed on the Commonwealth Heritage List (CHL).
Condition—Date	The condition noted here is at November 2011. The extant buildings and trees of Judith Wright Court continue to be well maintained for student accommodation and are in reasonable condition.
Relevant Documentation	There is no current documentation for this building.

### Context of the Buildings

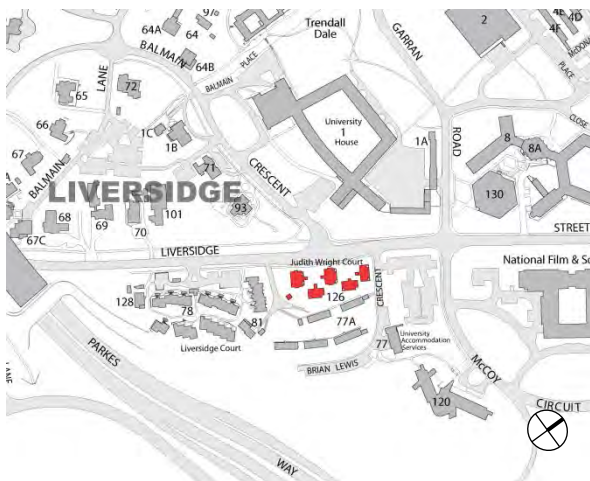

Figure 2: Judith Wright Court in relation to the Liversidge section of the campus.

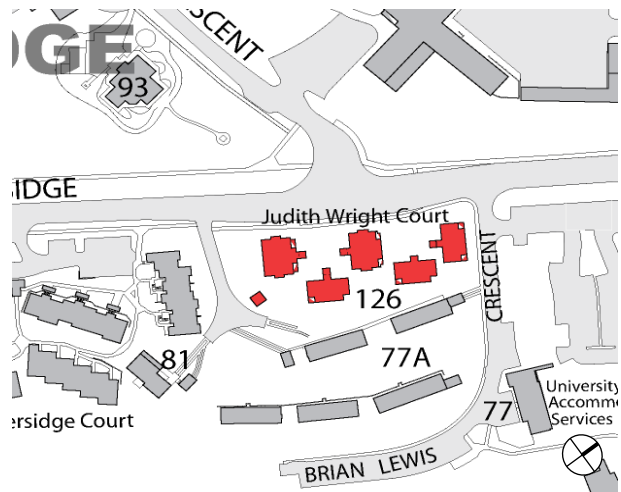

Figure 3: Configuration of Judith Wright Court on Liversidge Street.

### Brief Historical Overview

This complex is of recent construction, being opened in 2001 by Peter Garrett. It is sited on the area between the Brian Lewis Crescent houses and Liversidge Street. Originally designed as 'Liversidge Court Stage 2' in 2000, it was renamed Judith Wright court after the renowned poet. The site includes sculpted work by Ante Dabro.

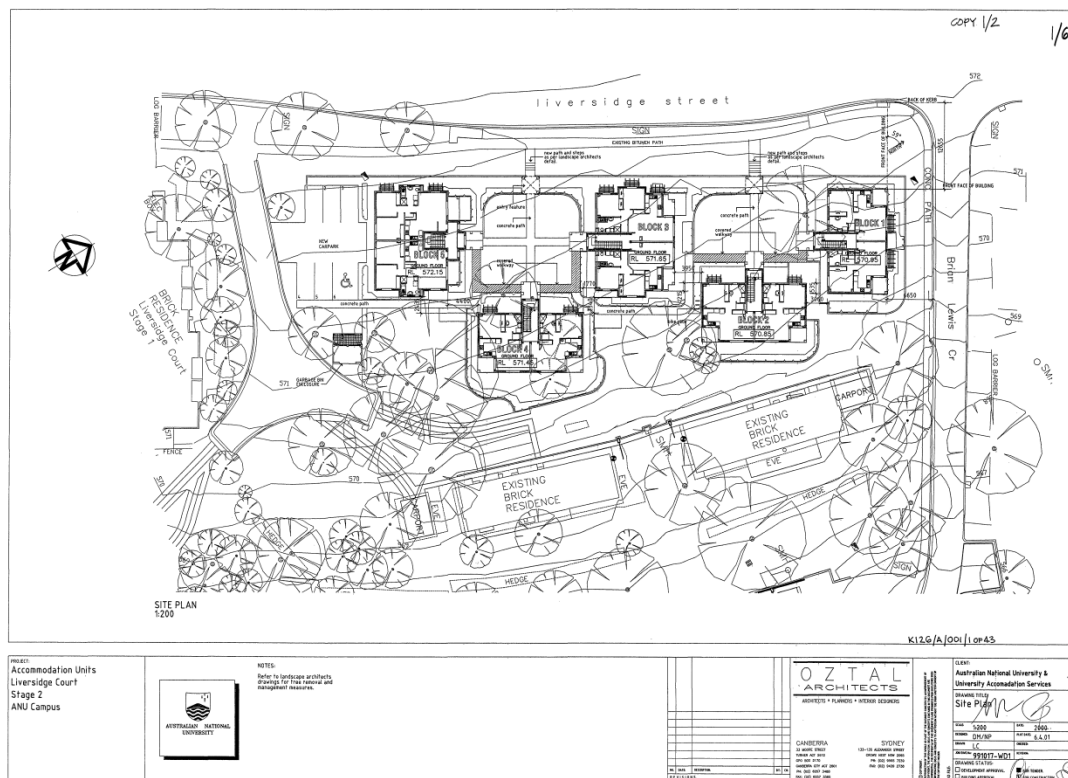

Figure 4: The 2000 site plan of Judith Wright Court (then Liversidge Court stage 2) in relation to Liversidge Street and Brian Lewis Crescent.

## Description of Judith Wright Court

### Buildings

The buildings are a set of five 2 and 3 storey brick buildings with terracotta tile roofs, a housing studio, 1 and 2 bedroom apartments. The upper floors of all buildings are rendered in a warm cream render with the ground floor retaining a plain redbrick finish. Windows are a combination of aluminium framed, sliding and top hung casements with intermittent wooden external shading features. External plumbing and guttering is powdercoated colorbond steel to match the colouring of the roof tiles and horadings as well as the rendered walls. Each building has a portico at the main entrance finished in the same style as the buildings.

The interiors are painted plasterboard with combination flooring of carpet and tile in appropriate areas. It also includes modern fixtures and appliances installed in 2001.

### Landscape

The surrounding area is neatly landscaped with a combination of native and exotic plantings. It also includes a water feature in the main courtyard which has a bronze sculpture by artist Ante Dabro entitled *Contemplation*. The Entrance to the site includes a stand-alone portico rendered and tiled to match the style of the main buildings.

## Significance Assessment against the Commonwealth Heritage criteria

### Statement of Significance

N/A

Criteria	Assessment
<b>(a) Historic</b> The place has significant heritage value because of the place's importance in the course, or pattern, of Australia's natural or cultural history.	Judith Wright Court does not meet CHL criterion (a) for historic values.
<b>(b) Rarity</b> The place has significant heritage values because of the place's possession of uncommon, rare or endangered aspects of Australia's natural or cultural history.	Judith Wright Court does not meet CHL criterion (b) for rarity values
<b>(c) Scientific</b> The place has significant heritage value because of the place's potential to yield information that will contribute to an understanding of Australia's natural or cultural history.	Judith Wright Court does not meet CHL criterion (c) for scientific values

<p><b>(d) Representative</b> The place has significant heritage value because of the place's importance in demonstrating the principal characteristics of: A class of Australia's natural or cultural places; or A class of Australia's natural or cultural environments.</p>	<p>Judith Wright Court does not meet CHL criterion (d) for representative values</p>
<p><b>(e) Aesthetic</b> The place has significant heritage value because of the place's importance in exhibiting particular aesthetic characteristics valued by a community or cultural group.</p>	<p>Judith Wright Court does not meet CHL criterion (e) for aesthetic values</p>
<p><b>(f) Creative/Technical</b> The place has significant heritage value because of the place's importance in demonstrating a high degree of creative or technical achievement at a particular period.</p>	<p>Judith Wright Court does not meet CHL criterion (f) for creative/technical values</p>
<p><b>(g) Social</b> The place has significant heritage value because of the place's strong or special association with a particular community or cultural group for social, cultural or spiritual reasons.</p>	<p>Judith Wright Court does not meet CHL criterion (g) for social values</p>
<p><b>(h) Associative</b> The place has significant heritage value because of the place's special association with the life or works of a person, or group of persons, of importance in Australia's natural and cultural history.</p>	<p>Judith Wright Court does not meet CHL criterion (h) for associative values</p>
<p><b>(i) Indigenous</b> The place has significant heritage value because of the place's importance as part of Indigenous tradition.</p>	<p>Judith Wright Court does not meet CHL criterion (i) for Indigenous values</p>



## Photographs



Figure 5: Front Entrance to Judith Wright Court including portico. (Source: ANU Heritage Office 2011)



Figure 6: Front entrance to Block 5 including portico, wooden window features and examples of window styles. (Source: ANU Heritage Office.)



Figure 7: Commemorative plaque of the opening of Judith Wright court in 2002. (Source: ANU Heritage Office 2011)



Figure 8: 'Contemplation' 2002, by Ante Dabro. (Source: ANU Heritage Office 2011)

### Photographs



**Figure 9** Main Courtyard with water feature and sculpture, also displaying native and exotic plantings. (Source: ANU Heritage Office 2011)



**Figure 10** View of Block 1 of Judith Wright Court, showing the 2 storey version of building construction. (Source: ANU Heritage Office 2011)

### Management Issues

#### Constraints and Opportunities

As Judith Wright Court is of neutral significance, no **constraints** are noted.

The Judith Wright Court is ranked as being of 'Neutral' significance as it does not embody, reflect or demonstrate Commonwealth or National Heritage values. The building makes no contribution to the site nor does it detract from the overall heritage values of the ANU Acton campus.

The **Tolerance for Change** heritage management tool, outlined in Section 7.6 of the ANU Acton Campus Heritage Study 2012, will assist in conserving heritage values through a process of change. The Judith Wright Court is able to tolerate a substantial amount of change through development. Removal of neutral elements is not necessary unless it allows for heritage values of the campus to be regained, reinforced or conserved.

As Judith Wright Court is of neutral significance, no **opportunities** are noted.

#### Recommendations

Photographic recording for the ANU archives should be undertaken prior to substantial change to buildings or landscaping in any future development.